

The logo features the text "PEARSON DENTAL" in a bold, black, sans-serif font. The text is centered within a yellow oval that has a thin white border. This oval is set against a brown background. A thick, yellow rope with a black outline is coiled around the oval, forming a rectangular frame with rounded corners. The rope has a detailed three-strand braid pattern.

PEARSON DENTAL

supplies

Pearson®

Dental Supply Company

pearsondental.com

pearsonlab.com
pearsonsurgical.com
pearsonortho.com

pearsoncadcam.com
pearsonendo.com
pearsonimplant.com

Hygident®

Chromatic Alginate

Mint Fast Set

1 lb.

H79-0004

\$5.99



Lidocaine

1:100,000

Pkg of 50

E21-0585

\$35.10

Buy 10, Get 1 FREE.

Net \$31.91

Free goods ship with order.



Orabloc

1:100,000

1.8ml Cartridges

Pkg of 50

P96-0002

\$39.99



vivid®

NumbGel

anesthetic gel

9 flavors

1-oz jar \$4.50

Buy 5 jars get 1 free.

Net Price \$3.75

Free goods ship with order.



vivid®

Flavorbite

Premium flavored VPS bite

registration material

50ml cartridges

2-pack w/ mixing tips

Vanilla B31-0378

Berry B31-0382

\$19.50

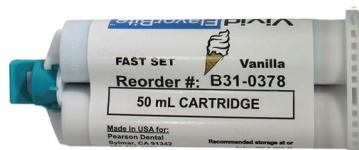

vivid®

Flavormatch

Premium flavored VPS

impression material

50ml Cartridges

Available in Mint & Berry.

Light, heavy, regular & fast set.

Pkg of 4

\$29.99



Dent@zon

DX-Mixer Wings

(mixing tips)

Mixing tips for dental impression material designed to produce a consistent yet successful mixing outcome. Color-coded wings provide easier type identification and enhanced grip.

Pkg of 48

Teal Z04-0470

Yellow Z04-0472

\$16.00



vivid®

Prokleen

Prophy Paste

1.23% fluoride in a phosphate mixture.

Non splatter prophy paste for superior polishing and stain removing, easily rinses off. Made in USA. Mint coarse.

Pkg of 200

M09-1012

\$16.50



vivid®

Slimpro

Latex-free Prophy Angles

New ergonomic design for maximizing

patient comfort and posterior access.

Unique pre-lubricated gearing for smooth performance. Available in soft or firm cups.

Box of 100

\$19.99

Box of 500

\$90.00



Glacier Blue Nitrile

NEW Naturals Powder Free Nitrile Exam Gloves are inspired by nature. 300 piece compact packaging reduces the amount of waste by up to 60%. Excellent tactile sensitivity.

Pkg of 300

\$14.50

Buy 7, Get 3 FREE

Net \$10.15



best deals on equipment

Take advantage of **section 179**

Up to \$1,000,000 in tax deductions.
Call for details.



vatech

i3D Smart

- 12 x 9 FOV
- 80µm voxel
- **10-year warranty**
- Includes 3D implant software
- Includes installation, training and support



vatech

i3D Smart RC

- 12 x 9 FOV
- 80µm voxel
- **10-year warranty**
- Includes 3D implant software
- Includes installation, training and support



MyRay X5 3D Panoramic

\$748 + tax per month

- 10 x 10 FOV
- 80 µm voxel
- Includes 3D implant software
- Includes installation, training & computer



X-9 Pan Ceph 3D CBCT

\$969 + tax per month

- Up to 11 x 13 FOV
- 75 µm voxel
- Includes 3D implant software
- Includes installation, training & computer



Build your new office with us.

Architectural design, permit expediting, construction, financing, IT solutions, project management, equipment sales, installation and service.

New office workhorse bundle

- 3 Belmont operatory packages
- Midmark compressor and vacuum
- Midmark sterilizer
- Belmont intraoral x-ray
- Sota Clio digital sensor with imaging software
- 2 Center island cabinets
- 2 Side cabinets
- 3 Rear cabinets

\$79,995 or \$1,330 + tax per month

Add additional rooms to take advantage of further savings.

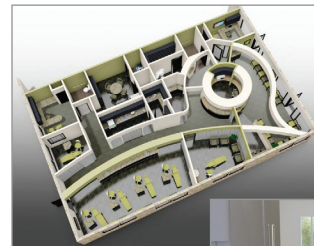

Belmont
DENTAL EQUIPMENT

MIDMARK



equipment@pearsondental.com (800) 474-2299

Pricing cannot be combined with any other discounts or promotions.

best deals on equipment



Introducing the Stern Weber S300 International Package

- Micromotor
- Scaler
- Curing light
- Bioster handpiece flush
- Pneumatic headrest
- Implant mode w/ library
- Apex locator
- Multimedia adapter



R7 International Package

Options:

- Micromotor
- Built-in scaler
- Curing light
- Pneumatic headrest

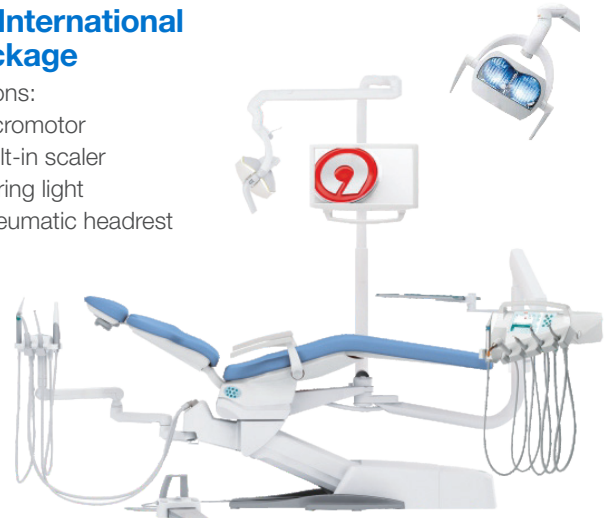

DentalEZ Core Operatory Package: \$9,495

Package includes:

- DentalEZ Core Chair
- DentalEZ Core Delivery System
- DentalEZ Core LED Light
- Dr. and Assistant Stool



Complete Quolis Package: Starting at \$16,995

Package includes:

- Quolis 5000 chair
- Quolis delivery w/ rear vac pkg
- Quolis light

*Optional Bel Halo LED Light shown



Complete Belmont Operatory Package: Starting at \$10,495

- Belmont Bel50N Dental Chair
- Belmont BDS2510 Delivery System w/ Vac Pkg
- Belmont Clesta LED Light

*Optional cuspidor shown



Pearson Operatory Package: \$8,995

Package includes:

- Belmont Bel50N Dental Chair
- DCI Newberg II Delivery System w/ Vac Pkg
- Belmont Clesta LED Light



Pricing cannot be combined with any other discounts or promotions.

equipment@pearsondental.com (800) 474-2299



Take advantage of **section 179**

Up to \$1,000,000 in tax deductions.
Call for details.

best deals on equipment

Take advantage of **section 179**

Up to \$1,000,000 in tax deductions.
Call for details.

GENDEX



GXS-700™
Digital Intraoral Sensor
\$7,995 trade-in price,
call for details

clio
DIGITAL X-RAY SENSORS



Clio Sensor
Starting \$4,995
Integrates with Eaglesoft,
Dexis, Vixwin Platinum,
Apertyx, XDR, Eva Soft

SUNI

Suni IQ Sensor
Bundle
Only \$8,000

Bundle includes:

- Any two Suni IQ Digital Sensors, can choose between size 1 or size 2
- Ask about imaging software promotion.



sota
IMAGING

i4D Intraoral Camera

- Unique hand control focus
- High end lens focus
- Compatible with almost all dental imaging software

\$2,295



ACTEON

Soprolife/ SoproCare
Combo Promo

- Superior caries & plaque detection
- Two cameras for \$7,495
- Two free docking stations
- While supplies last

Ask about our
\$750 rebate



KAVO

Nomad Pro2™
Hand-held
X-ray

- Innovative Carbon Nano Tubehead

Call about our
\$500 rebate.



MIDMARK

Progeny
Preva DC
\$350 rebate

Expires 12/31/18



vatech

EzRay
Intra-oral X-ray
\$3495



myray

RXDC eXTend
\$2995



MEDIT



NEW

i500 Intraoral Scanner

- **COLOR SCANS**
- No monthly fees
- No powder
- Open STL files

Call for special
pricing.

MIDMARK

M3, M9 or M11
Autoclave
\$500 rebate

Expires 12/31/18



SciCan

Statim G4 Series
Up to \$300 rebate



ACCUTRON

Ultra PC® Flowmeter
+ Portable Nitrous Cart
Model 36100
\$3,495

- Ability to decrease flow rate to 1 LPM.
- 2 year warranty

\$500
rebate
available



Pearson

equipment@pearsondental.com (800) 474-2299

Pricing cannot be combined with any other discounts or promotions.

The logo features the text "XCEL SEMINARS" in a bold, black, sans-serif font, centered within a yellow oval. This oval is surrounded by a thick, yellow rope that forms a rectangular border with rounded corners. The rope has a detailed braided texture and is set against a solid brown background.

XCEL SEMINARS



14th Annual Comprehensive Dental Skills Series

Knott's Berry Farm Resort Hotel

Nov. 4, 2018 Hands-on Oral Surgery & Setting the Stage for Optimal Ridge Preservation
Dr. Ron Wang has received extensive training in oral and periodontal surgery, implants and fixed prosthetics.

Dec. 2: Revolutionary Endo-Using Biomimetic Principles to Preserve & Save More Teeth, with a Hands-on Demo! *Dr. Robert Salehrabi is back by popular demand for this brand new topic! He maintains a private practice, is an Associate Professor of Clinical Endodontics at USC and a recommended speaker of the American Association of Endodontists.*

Dec. 16: Digital Dentistry for Impressioning, Workflow and Treatment Planning Implant Cases *Dr. Chad Duplantis is a renowned author and lecturer about "high-tech" dentistry.*

Jan. 20, 2019: Clinical Treatment Planning and Problem Solving – When It Doesn't Go By the Book *Dr. Bob Lowe has authored numerous articles, contributions to textbooks and is consistently named a "Top 100 Clinician in Dentistry."*

Feb. 24: Clarifying the Confusion: Ceramics, Cementing & Bonding *Dr. Troy Schmedding is one of only hundreds of dentists, world wide accredited from the American Academy of Cosmetic Dentistry. He also maintains Diplomate status with the American Board of Cosmetic and Esthetic Dentistry and is a sought after restorative lecturer.*

Knott's Berry Farm Resort Hotel, 7675 Crescent Ave, Buena Park, CA
(Beach Blvd. exit of the 5, 405 & 91 Fwys)

ALL COURSES ARE ON SUNDAYS (8AM-4PM) AND 7 CA CEs EACH
\$149 PER LECTURE, \$399 FOR THE HANDS-ON
ORAL SURGERY OR THE ENTIRE 5 COURSE SERIES
(INCLUDING HANDS-ON COURSE, 35 CA & AGD CEs)
FOR ONLY \$599!

COURSE SERIES
SPONSORED BY:

Geistlich
Biomaterials

GC

GLIDEWELL
DENTAL

SDI

septodont

SHOFU

BISCO

premier

kuraray

COURSE TOPICS

Hands-on Intro to Oral Surgery and Ridge Preservation (this course on surgical models is included in the course series): *This comprehensive program will show hands-on surgical extractions and socket grafting. Topics Include:* Gain a greater appreciation for diagnosis and assessment of tooth root anatomy and alveolar shape and form ♦ Understanding the socket anatomy based treatment algorithm ♦ Understand how to treatment plan in the best way to reach the desired outcome ♦ Learn the principles of minimally traumatic tooth extraction ♦ Gain an understanding of the biology of ridge resorption after extraction of a tooth ♦ Learn about the biofunctionality of biomaterials and its influence on extraction socket healing ♦ (HANDS-ON) Practice important techniques for minimally invasive tooth extraction plus preparing and placing biomaterials to achieve optimal ridge preservation

Revolutionary Endo: *This seminar covers the latest research and techniques, based on Biomimetic principals of maximizing tooth structure, for having endodontic success in your practice. Dr. Salehrabi will show numerous cases to teach the following:* Appropriate case selection ♦ Executing wholistic diagnosis methods to find the right tooth and treat it correctly ♦ Maximizing improvements in file technologies to improve outcomes and preserve tooth structure ♦ Using cutting-edge materials to biomimetically mimic natural dentine, providing a range of effective treatment options in addition to standard root canals and restorations after performing root canals.

Digital Dentistry: Treatment planning, designing and executing complex restorative and esthetic cases, especially those involving implants and fixed prosthodontics are daunting. Digital dental workflows have made this process more efficient and rewarding. We will discuss the rise in success that dentists and laboratories are experiencing with digital methods. This course will guide you step-by-step how to have success creating and restoring single units, implants and complex restorative cases digitally, showing you many practical clinical "gems" via numerous successful and failed cases, to improve your removable and fixed prosthodontic skills. This course will also briefly touch upon digital dentures.

Clinical Treatment Planning and Problem Solving: *Dr. Lowe will discuss creative ways to handle situations "that don't necessarily follow the textbook", to save time AND money, let alone avert a clinical failure! Topics include:* Treatment options for complex cases: Do you have a "Plan B"? Can you think "outside the box" for solutions to not only be a "textbook" treatment planner? ♦ Materials options for restorative dentistry: Choosing the best materials based on clinical circumstances (being the doctor!) ♦ Multidisciplinary Treatment Planning: The Periodontal Restorative Connection and the Importance of a "Solid Foundation." ♦ No Prep Veneers: Manufacturer "hype" or realistic clinical option? How new dental materials can make this a more realistic approach for some cases. ♦ Instant Orthodontics: Viable treatment option or "quick fix cop out" revisited - prosthetic tooth repositioning for aesthetics and function limitations and long-term results ♦ Creative Treatment Planning and Execution.... It's all in the details and it's all about the options! Case reviews that "don't necessarily fit" classic treatment protocols ♦ Can orthognathic surgery and orthodontics be done with only crown and bridge??

Clarifying the Confusion in Adhesion Dentistry: *This course will present advanced adhesion techniques and materials supported by important key research that minimize the removal of healthy tissue and maximize bond strengths, including:* Immediate dentin sealing: the most important advancement in adhesion dentistry and why it dramatically increases dentin bond strengths for direct and indirect restorations ♦ A minimally invasive approach to tooth preparation ♦ How to elevate deep margins with direct composite ♦ How adhesive materials react to and interact with natural tooth structure ♦ Temporization of minimally prepared teeth ♦ How to treat cracks in dentin

TUITION	5 COURSE SERIES	EACH INDIVIDUAL COURSE
More than 14 days before an event	Dentist: \$599, Staff: \$299 Includes Hands-on Oral Surgery	Lecture Dentist: \$149, Staff: \$129 \$399 for Hands-on Oral Surgery course
Less than 14 days before an event	Dentist: \$619, Staff: \$319 Includes Hands-on Oral Surgery	Lecture Dentist: \$169, Staff: \$149 \$419 for Hands-on Oral Surgery course

Fees include continental breakfast, CE credits and free hotel parking. Registration is at 7:30am, courses are 8am-3:30pm. It is an extra \$20 fee for all onsite and walk-in registrations.

Last Name _____ First Name _____ Email _____ Phone _____

Address _____ City _____ State _____ Zip _____

Cancellation Policy: Series registration is non-refundable. For individual courses, with written cancellation at least 14 days prior to a seminar, a refund will be issued less a \$50 cancellation fee. No refund or credit less than 14 days from an event.

Additional registrants _____ Course Dates: _____ Total Amount _____

Register online at www.xcelseminars.com

Mail checks: Xcel Seminars, PO Box 441745, Aurora, CO 80044 • If you have any questions please call Janine at 480-717-2230 • Fax: (866) 332-5891

Although Xcel Seminars does have sponsorship relationships with dental manufacturers and suppliers, we are dedicated to providing only evidence-based information in our courses.



Approved PACE Program Provider FAGD/MAGD Credit Approval does not imply acceptance by a state or provincial board of dentistry or AGD endorsement. (10/01/15) to (09/30/2019) We are a California Board Approved provider, permit #4536.