

The logo features the text "PEARSON DENTAL" in a bold, black, sans-serif font. The text is centered within a yellow oval that has a thin white border. This oval is set against a brown background. A thick, yellow rope with a black outline is coiled around the oval, forming a rectangular frame with rounded corners. The rope has a detailed braided texture.

**PEARSON DENTAL**

# supplies

**Pearson®**

Dental Supply Company  
pearsondental.com

pearsonlab.com  
pearsonsurgical.com  
pearsonortho.com

pearsoncadcam.com  
pearsonendo.com  
pearsonimplant.com

Hygident®

## Chromatic Alginate

Mint Fast Set  
1 lb.  
H79-0004  
**\$5.99**



## Lidocaine

1:100,000  
Pkg of 50  
E21-0585  
**\$35.10**  
**Buy 10, Get 1 FREE.**  
**Net \$31.91**  
Free goods ship with order.



## Orabloc

1:100,000  
1.8ml Cartridges  
Pkg of 50  
P96-0002  
**\$39.99**



vivid®

## NumbGel

anesthetic gel  
9 flavors  
**1-oz jar \$4.50**  
**Buy 5 jars get 1 free.**  
**Net Price \$3.75**  
Free goods ship with order.



vivid®

## Flavorbite

Premium flavored VPS bite registration material  
50ml cartridges  
**2-pack w/ mixing tips**  
Vanilla B31-0378  
Berry B31-0382  
**\$19.50**

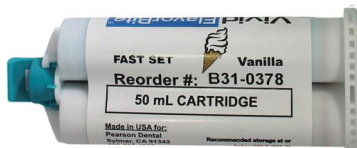

vivid®

## Flavormatch

Premium flavored VPS impression material  
50ml Cartridges  
Available in Mint & Berry.  
Light, heavy, regular & fast set.  
Pkg of 4  
**\$29.99**



Dent@zon

## DX-Mixer Wings (mixing tips)

Mixing tips for dental impression material designed to produce a consistent yet successful mixing outcome. Color-coded wings provide easier type identification and enhanced grip.  
Pkg of 48  
Teal Z04-0470  
Yellow Z04-0472  
**\$16.00**



vivid®

## Prokleen

Prophy Paste  
1.23% fluoride in a phosphate mixture.  
Non splatter prophy paste for superior polishing and stain removing, easily rinses off. Made in USA. Mint coarse.  
Pkg of 200  
M09-1012  
**\$16.50**



vivid®

## Slimpro

Latex-free Prophy Angles  
New ergonomic design for maximizing patient comfort and posterior access.  
Unique pre-lubricated gearing for smooth performance. Available in soft or firm cups.  
Box of 100  
**\$19.99**  
Box of 500  
**\$90.00**



## Glacier Blue Nitrile

NEW Naturals Powder Free Nitrile Exam Gloves are inspired by nature. 300 piece compact packaging reduces the amount of waste by up to 60%. Excellent tactile sensitivity.  
Pkg of 300  
**\$14.50**  
**Buy 7, Get 3 FREE**  
**Net \$10.15**



best deals on equipment

Take advantage of **section 179**

Up to \$1,000,000 in tax deductions.  
Call for details.



**vatech**

**i3D Smart**

- 12 x 9 FOV
- 80µm voxel
- **10-year warranty**
- Includes 3D implant software
- Includes installation, training and support



**vatech**

**i3D Smart RC**

- 12 x 9 FOV
- 80µm voxel
- **10-year warranty**
- Includes 3D implant software
- Includes installation, training and support



**MyRay X5 3D Panoramic**

**\$748 + tax per month**

- 10 x 10 FOV
- 80 µm voxel
- Includes 3D implant software
- Includes installation, training & computer



**X-9 Pan Ceph 3D CBCT**

**\$969 + tax per month**

- Up to 11 x 13 FOV
- 75 µm voxel
- Includes 3D implant software
- Includes installation, training & computer



## Build your new office with us.

Architectural design, permit expediting, construction, financing, IT solutions, project management, equipment sales, installation and service.

### New office workhorse bundle

- 3 Belmont operatory packages
- Midmark compressor and vacuum
- Midmark sterilizer
- Belmont intraoral x-ray
- Sota Clio digital sensor with imaging software
- 2 Center island cabinets
- 2 Side cabinets
- 3 Rear cabinets

**\$79,995 or \$1,330 + tax per month**

Add additional rooms to take advantage of further savings.

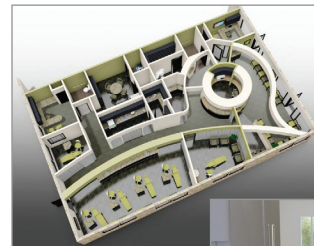

**Belmont**  
DENTAL EQUIPMENT

**MIDMARK**



equipment@pearsondental.com (800) 474-2299

Pricing cannot be combined with any other discounts or promotions.

# best deals on equipment



## Introducing the Stern Weber S300 International Package

- Micromotor
- Scaler
- Curing light
- Bioster handpiece flush
- Pneumatic headrest
- Implant mode w/ library
- Apex locator
- Multimedia adapter



## R7 International Package

Options:

- Micromotor
- Built-in scaler
- Curing light
- Pneumatic headrest

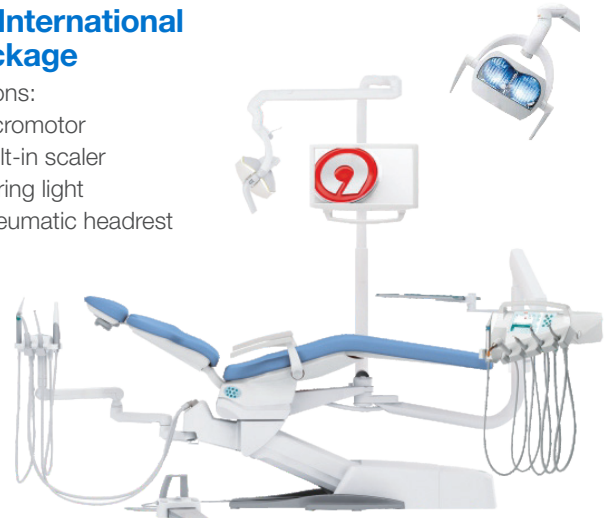

## DentalEZ Core Operatory Package: \$9,495

Package includes:

- DentalEZ Core Chair
- DentalEZ Core Delivery System
- DentalEZ Core LED Light
- Dr. and Assistant Stool



## Complete Quolis Package: Starting at \$16,995

Package includes:

- Quolis 5000 chair
- Quolis delivery w/ rear vac pkg
- Quolis light

\*Optional Bel Halo LED Light shown



## Complete Belmont Operatory Package: Starting at \$10,495

- Belmont Bel50N Dental Chair
- Belmont BDS2510 Delivery System w/ Vac Pkg
- Belmont Clesta LED Light

\*Optional cuspidor shown



## Pearson Operatory Package: \$8,995

Package includes:

- Belmont Bel50N Dental Chair
- DCI Newberg II Delivery System w/ Vac Pkg
- Belmont Clesta LED Light



Take advantage of **section 179**

Up to \$1,000,000 in tax deductions.  
Call for details.



best deals on equipment

Take advantage of **section 179**

Up to \$1,000,000 in tax deductions.  
Call for details.

**GENDEX**



**GXS-700™**  
**Digital Intraoral Sensor**  
**\$7,995 trade-in price,**  
**call for details**

**clio**  
DIGITAL X-RAY SENSORS



**Clio Sensor**  
**Starting \$4,995**  
Integrates with Eaglesoft,  
Dexis, Vixwin Platinum,  
Apertyx, XDR, Eva Soft

**SUNI**

**Suni IQ Sensor**  
**Bundle**  
**Only \$8,000**

Bundle includes:

- Any two Suni IQ Digital Sensors, can choose between size 1 or size 2
- Ask about imaging software promotion.



**sota**  
IMAGING

**i4D Intraoral Camera**

- Unique hand control focus
- High end lens focus
- Compatible with almost all dental imaging software

**\$2,295**



**ACTEON**

**Soprolife/ SoproCare**  
**Combo Promo**

- Superior caries & plaque detection
- Two cameras for \$7,495
- Two free docking stations
- While supplies last

**Ask about our**  
**\$750 rebate**



**KAVO**

**Nomad Pro2™**  
**Hand-held**  
**X-ray**

- Innovative Carbon Nano Tubehead

**Call about our**  
**\$500 rebate.**



**MIDMARK**

**Progeny**  
**Preva DC**  
**\$350 rebate**

Expires 12/31/18



**vatech**

**EzRay**  
**Intra-oral X-ray**  
**\$3495**



**myray**

**RXDC eXTend**  
**\$2995**



**MEDIT**



**NEW**

**i500 Intraoral Scanner**

- **COLOR SCANS**
- No monthly fees
- No powder
- Open STL files

**Call for special**  
**pricing.**

**MIDMARK**

**M3, M9 or M11**  
**Autoclave**  
**\$500 rebate**

Expires 12/31/18



**SciCan**

**Statim G4 Series**  
**Up to \$300 rebate**



**ACCUTRON**

**Ultra PC® Flowmeter**  
**+ Portable Nitrous Cart**  
Model 36100  
**\$3,495**

- Ability to decrease flow rate to 1 LPM.
- 2 year warranty

**\$500**  
**rebate**  
**available**



**Pearson**

equipment@pearsondental.com (800) 474-2299

Pricing cannot be combined with any other discounts or promotions.

The logo features the text "XCEL SEMINARS" in a bold, black, sans-serif font, centered within a yellow oval. This oval is surrounded by a thick, yellow rope border that forms a rectangular shape with rounded corners. The rope has a detailed braided texture and is set against a solid brown background.

# **XCEL SEMINARS**



# 15th Annual Comprehensive Dental Skills Series

Four Points Sheraton San Jose

**Nov 18, 2018: Dental Pharmacology and Local Anesthesia** *Dr. Patrick Quaranta* is back by popular demand for a new subject (even if you have taken his previous Pharmacology course you do NOT want to miss this one)! He is a former professor of Oral Medicine at UMDNJ-New Jersey Dental School.

**Dec. 16: OSHA, Infection Control & the California Dental Practice Act PLUS How to Grow Manage & Protect your Practice.** *Pat Wood*, Partner at Wood & Delgado is an expert on the Dental Practice Act and Dental Transitions. *Carrie Ibbetson, RDH*, uses her unique humor and cutting edge information to present tough subject matter in an interesting way.

**Jan. 27: Silver Bullets: Simple and Magical Solutions to Pediatric Dentistry's Complicated Problems** *Dr. Jarod Johnson* is a Pediatric Specialist has received advanced training in behavior management, sedation, hospital dentistry, trauma, special health care needs, interceptive orthodontics & space maintenance.

**Feb. 17: Dental Implants: The Expanding Role of the General Dentist** *Dr. Paul Goodman* teaches a streamlined process through his PPRMP Method: Planning, Placement, Restoration, Maintenance and Profit.

**March 31: Transform your Practice with New Advances in Caries Management** *Douglas A. Young DDS, EdD, MS, MBA*, is a Professor at the UoPacific where he is an ardent educator of minimally invasive dentistry and cariology. Dr. Young served on the ADA Council of Scientific Affairs (2012-2016) and is currently a member of the ADA Evidence-based Dentistry (EBD) Leaders Network and a cariology consultant for the ADA.

**Four Points Sheraton San Jose 1471 N 4th St, San Jose, CA 95112 (408) 452-0200**  
(Minutes from 680 & 101 Fwys)

**ALL COURSES ARE ON SUNDAYS & 7 CA & AGD CEs EACH**  
**\$195 FOR EACH LECTURE**  
**OR THE ENTIRE 5 COURSE SERIES**  
**(35 CA & AGD CEs) FOR ONLY \$549**

**BONUS  
HANDS-ON  
COURSE:  
ONLY  
\$299**

**March 17: Hands-on Innovations in Minimally Invasive Bioceramic Materials and Procedures**  
*Dr. Randall Cohen* is an instructor with the Alleman-Deliperi Center for Biomimetic Dentistry, and has published and lectured extensively on biomimetic dentistry.

COURSE SERIES  
SPONSORED BY:



## COURSE TOPICS

**Dental Pharmacology and Anesthesia** *including:* Use, overuse and underuse of drugs in dentistry and "off label" use of drugs, including: Antifungal medications ♦ Antiviral drugs ♦ Sterioids ♦ Local Anesthetics - Topical and Injectable (including a Live demo of better injection methods for your patients)! The techniques for delivery of the newly discovered STA-Intraligamentary Injection, administration of comfortable palatal injections (AMSA & P-ASA) that anesthetizes multiple maxillary teeth and related gingival tissues without collateral anesthesia ♦ How to easily anesthetize a single tooth with efficacy, safety, and comfort, but without producing collateral numbness and possible injury to a child's lips or tongue ♦ How to minimize a child's disruptive behavior and your stress during anesthesia

**OSHA, Infection Control and the CA Dental Practice Act:** *This course will not only entertain you and your staff but will enable attendees to meet license renewal requirements and state and federal requirements for OSHA Bloodborne Pathogen training, and infection Control with Carrie Ibbetson. The California Dental Practice Act segment will include:* Basic requirements of the Dental Board, how to avoid Dental Board problems AND Present actual case studies of dentists subjected to Board discipline. PLUS a Bonus Course-How to Grow, Manage and Protect Your Practice: Whether you own dental practice or are an associate, this bonus segment is for you!

**Hands-on Minimally Invasive Bioceramic Dentistry (not included in the series):** This course will explore the characteristics of biomimetic, minimally invasive treatment options and how they can be incorporated into daily practice. Clinical cases where deep caries or pulp exposures could be predictably treated without the need for endodontic treatment will be presented. Attendees will learn how to repair teeth and lessen sensitivity, use bioactive materials to strengthen teeth and reduce restorative failure and how to protect and prolong pulp vitality. A hands-on segment is included, giving you a chance to work with innovative products backed by scientific research with, excellent outcomes.

**Simple and Magical Pedo Solutions:** *This lecture course is designed to improve dentists' skills. Areas covered will include:* Treating immature teeth impacted by trauma or carries ♦ Obtaining the correct pulpal and periapical diagnosis ♦ Current research on dental materials, treatment planning, and case selection ♦ Silver diamine fluoride and no drill silver crowns (stainless steel crowns placed using the Hall Technique)

**GPs and Implants:** *Most restorative practices see at least one patient with a missing tooth every day and this course will:* Review a case selection protocol that identifies straightforward implant cases ♦ Demystify front desk insurance coding and billing strategies ♦ Identify staff systems that take the "hassle-factor" out of the parts and pieces of implants ♦ Discover how to work synergistically with your specialist ♦ Explore techniques for extraction and socket preservation (bone grafting) to build your own ideal implant sites ♦ Assess post-operative care management to ensure patient comfort and safety

**Advances in Caries Removal:** *Dentistry is shifting the caries treatment paradigm by treating them as a disease. This presentation will help you use new tools such as the ADA Caries Classification System, silver diamine fluoride (SDF), partial caries removal, and glass ionomer cement (GIC) to managing caries, including:* Developing evidence-based treatment options based on individual risk factors ♦ Using the ADA CCS to determine nonsurgical and surgical approaches ♦ Demonstrate how to use SDF and GIC to treat caries

TUITION	5 COURSE SERIES	EACH INDIVIDUAL COURSE
More than 14 days before an event	Dentist: \$549, Staff: \$399 Add Hands-on Bioceramics for \$299	Lecture Dentist: \$195, Staff: \$155 \$399 for Hands-on Bioceramics
Less than 14 days before an event	Dentist: \$569, Staff: \$419 Add Hands-on Bioceramics for \$319	Lecture Dentist: \$215, Staff: \$175 \$419 for Hands-on Bioceramics

Fees include continental breakfast, CE credits and free hotel parking. Registration is at 7:30am, the courses are 8am-3:30pm. It is an extra \$20 fee for all onsite and walk-in registrations.

Last Name \_\_\_\_\_ First Name \_\_\_\_\_ Email \_\_\_\_\_ Phone \_\_\_\_\_

Address \_\_\_\_\_ City \_\_\_\_\_ State \_\_\_\_\_ Zip \_\_\_\_\_

**Cancellation Policy:** Series registration is non-refundable. For individual courses, with written cancellation at least 14 days prior to a seminar, a refund will be issued less a \$50 cancellation fee. No refund or credit less than 14 days from an event.

Additional registrants \_\_\_\_\_ Course Dates: \_\_\_\_\_ Total Amount \_\_\_\_\_

**Register online at [www.xcelseminars.com](http://www.xcelseminars.com)**

Mail checks: Xcel Seminars, PO Box 441745, Aurora, CO 80044 • If you have any questions please call Janine at 480-717-2230 • Fax: (866) 332-5891

Although Xcel Seminars does have sponsorship relationships with dental manufacturers and suppliers,  
we are dedicated to providing only evidence-based information in our courses.



Approved PACE Program Provider FAGD/MAGD Credit Approval does not imply acceptance by a state or provincial board of dentistry or AGD endorsement. (10/01/15) to (09/30/2019) We are a California Board Approved provider, permit #4536.